

Vejledning til rumtermostat

1. Rumindstillinger

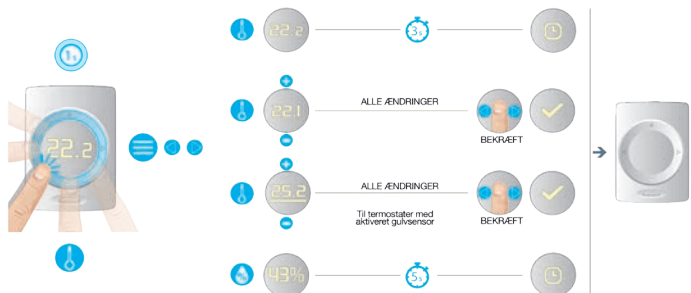

2. Rum komfortindstillinger

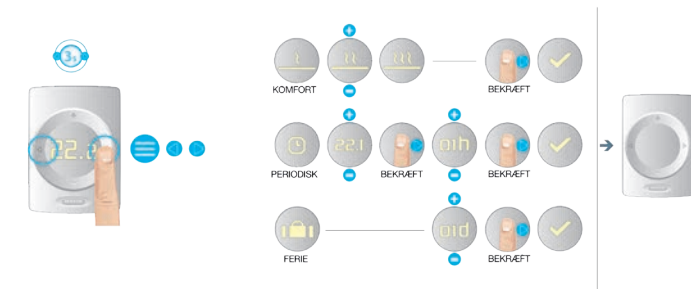

1. Udvidede indstillinger

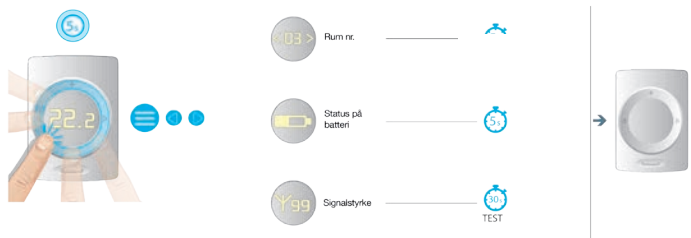

4. Lås | Lås op



5. Advarsel



→ Tjek manual

6. Fejl



→ Tjek manual

7a. Udskiftning af batterier | Fortrådet - Trådløs

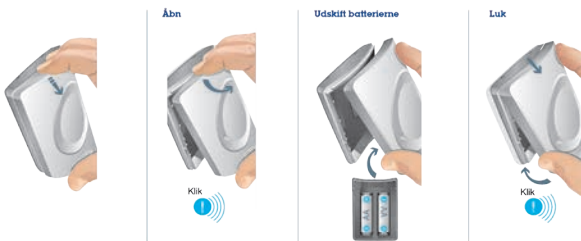

7b. Udskiftning af batterier | Håndholdt - Trådløs

