



LK FUGA®	506D0703 - 506D6703 - 540D6703 - 540D5703 540D8703
-----------------	---

⚠ ⚠ DANGER / FARE!

HAZARD OF ELECTRIC SHOCK, EXPLOSION OR ARC FLASH
 ■ Turn off all power supplying this equipment before working on the equipment.
 ■ Use a Voltage Tester of appropriate rating.
Failure to follow these instructions will result in death or serious injury.

RISIKO FOR ELEKTRISK STØD, EKSPLOSION ELLER LYSBUE
 ■ Afbryd strømforsyningen til dette denne indsats, før der foretages arbejdsopgaver på indsatsen.
 ■ Brug en spændingstester med passende måleangivelse.
Manglende overholdelse af disse instruktioner kan medføre død eller alvorlig personskade.

⚠ ⚠ DANGER / FARE!

HAZARD OF ELECTRIC SHOCK, EXPLOSION OR ARC FLASH
 If the USB charger insert is installed to replace a socket-outlet, connect the earth wires (PE) together with a junction block in order to have earth line continuity for all the socket outlets of this electrical circuit.
Failure to follow these instructions will result in death or serious injury.

RISIKO FOR ELEKTRISK STØD, EKSPLOSION ELLER LYSBUE
 Hvis USB strømforsyning installeres for at erstatte en stikkontakt, skal jordledningerne (PE) videresløjfes med samlemuffer for at sikre jordforbindelse til alle stikkontakter.
Manglende overholdelse af disse instruktioner kan medføre død eller alvorlig personskade.

en Connection

da Tilslutning

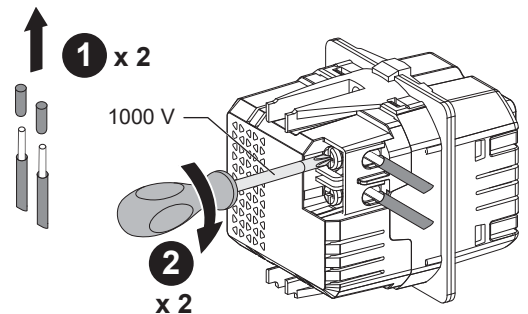
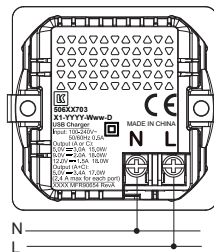
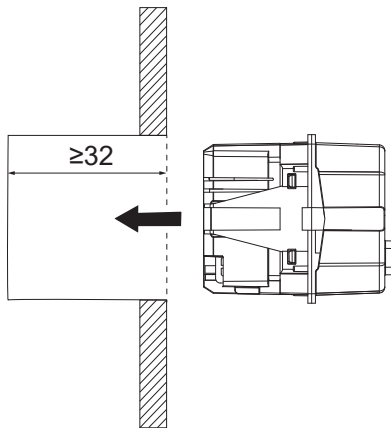

7 mm	0,75...2 x 2,5 mm ²		0,33 Nm	0,6 mm x 3,5 mm

en Use

da Anvendelse

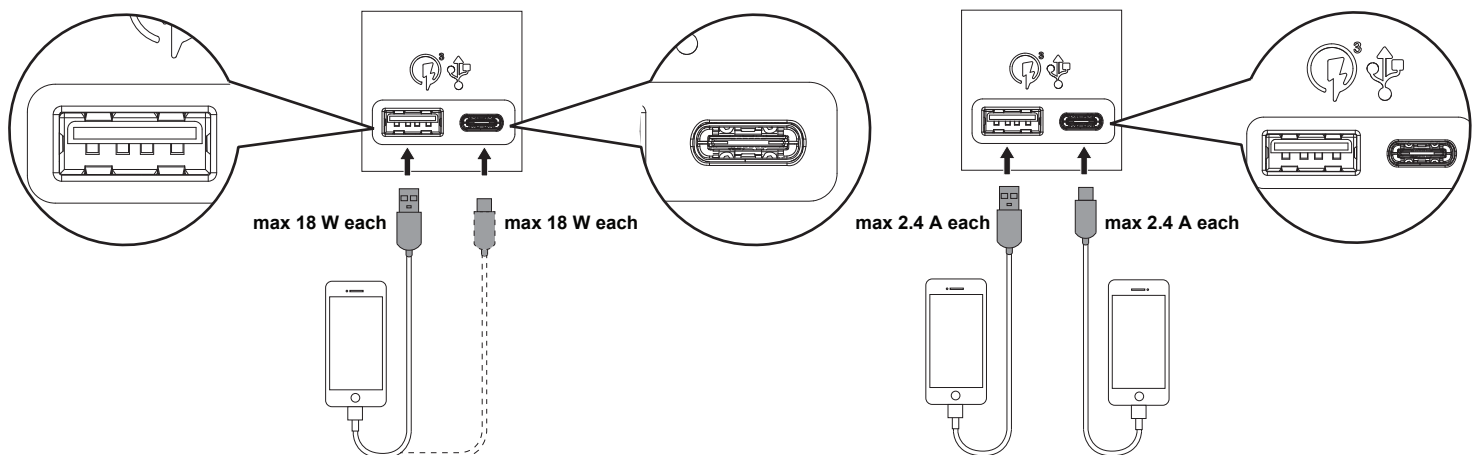

en Technical characteristics

Nominal input voltage:	100-240 V \sim \pm 10 %
USB output voltage:	Output (A or C): 5 V \equiv 3 A 15.0 W / 9 V \equiv 2 A 18.0 W / 12 V \equiv 1.5 A 18.0 W
Nominal output current:	Output (A+C): 5 V \equiv 3.4 A 17.0 W (2.4 A max for each port)
Charger Protocol (Type A alone):	QC3.0; QC2.0; Apple 2.4 A; FCP(5 V and 9 V); Samsung QC3.0; QC2.0; 2.1 A; AFC; BC1.2
Charger Protocol (Type C alone):	PD2.0; Apple 2.4 A; Samsung 2.1 A; BC1.2
Charger Protocol (Type A + C):	Apple 2.4 A; Samsung 2.1 A; BC1.2
No-load power consumption:	< 0.10 W
Maximum output power:	18.0 W
Expected lifetime:	30000 h
Overvoltage category:	OVC III
Isolation class:	Class II
Degree of protection:	IP20
Operating temperature:	0 °C - 40 °C
Operating humidity:	20% - 90% Non-Condensing
Energy efficiency:	COMMISSION REGULATION (EU) 2019/1782
Efficiency at low load (10%):	83.5%
Average active efficiency:	86.5%

da Tekniske data

Mærkespændning:	100-240 V \sim \pm 10 %
USB udgangsspænding:	Output (A eller C): 5 V \equiv 3 A 15.0 W / 9 V \equiv 2 A 18.0 W / 12 V \equiv 1,5 A 18.0 W
Mærkestrøm:	Output (A + C): 5 V \equiv 3,4 A 17.0 W (2,4 A max for hver port)
Opladerprotokol (Type A alene):	QC3.0; QC2.0; Apple 2.4 A; FCP(5 V and 9 V); Samsung QC3.0; QC2.0; 2.1 A; AFC; BC1.2
Opladerprotokol (Type C alene):	PD2.0; Apple 2.4 A; Samsung 2.1 A; BC1.2
Opladerprotokol (Type A + C):	Apple 2.4 A; Samsung 2.1 A; BC1.2
Strømförbrug uden belastning:	< 0.10 W
Maksimal udgangseffekt:	18.0 W
Forventet levetid:	30000 h
Overspændingskategori:	OVC III
Isolation klasse:	Klasse II
Kapslingsklasse:	IP20
Driftstemperatur:	0 °C - 40 °C
Luffugtighed:	20% - 90% Ikke-kondenserende
Energieffektivitet:	KOMMISSIONENS FORORDNING (EU) 2019/1782
Effektivitet ved lav belastning (10%):	83.5%
Gennemsnitlig aktiv effektivitet:	86.5%