

# TW LEDDim Smart Pill

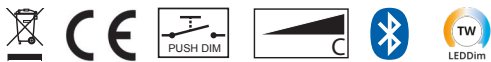

220-240V, 50/60Hz, 3-200VA, -20°C to 35°C

### Independent

0-1s

>1s

Max 50m

2x

1 sec. 1 sec.

### Built-in

0-1s

>1s

Max 50m

2x

1 sec. 1 sec.

|   |          |   |   |
|---|----------|---|---|
|   |          |   |   |
| ✗ | Max.160W | ✗ | ✗ |

Maximum number of luminaires: 11

✗

SG Armaturen AB

✗

SG Armaturen Oy

✗

✗

✗

✗

✗

0% 100%

Min. Max.

- ← → +

- +

**NO:** Minimum dimmenivåjustering  
**DA:** Minimum justering af dæmpningsniveau  
**SE:** Minsta justering av dimningsnivå  
**EN:** Minimum dimming level adjustment  
**FR:** Réglage du niveau de gradation minimal  
**NL:** Regelbaar niveau van minimale dimmingsgraad  
**DE:** Anpassung der minimalen Dimmstufe  
**FI:** Minimi himmennystaso

### Reset

1 ~1 sec.

2 -

R U - +

**NORWAY**  
SG Armaturen AS

Skytterheia 25  
N-4790 Lillesand

Tel: +47 37 50 03 00  
firmapost@sg-as.no  
www.sg-as.no

**SWEDEN**  
SG Armaturen AB  
Tel: +46 31 81 71 10  
info@sg-ab.se  
www.sg-ab.se

**FINLAND**  
SG Armaturen Oy  
Tel: +358 02 07 30 39 60  
info@sg-oy.fi  
www.sg-oy.fi

**DENMARK**  
SG Armaturen A/S  
Tel: +45 70 70 72 13  
info@sg-as.dk  
www.sg-as.dk

**UNITED KINGDOM**  
SG Lighting LTD  
Tel: +47 37 50 03 00  
info@sglighting.co.uk  
www.sglighting.co.uk

**FRANCE**  
SG Lighting SA/NV  
Tel: +33(0) 4 94 93 00 00  
info.france@sglighting.fr  
www.sglighting.net

**BENELUX**  
SG Lighting SA/NV  
Tel: +32(0) 15 20 72 71  
info.benelux@sglighting.net  
www.sglighting.net

**GERMANY**  
SG Leuchten GmbH  
Tel: +49 40 23 99 44 59  
info@sg-leuchten.de  
www.sg-leuchten.de

**INTERNATIONAL**  
SG Lighting Co Ltd.  
Tel: +86 769 88 49 20 88  
cindy@sgdgc.com  
www.sg-as.com

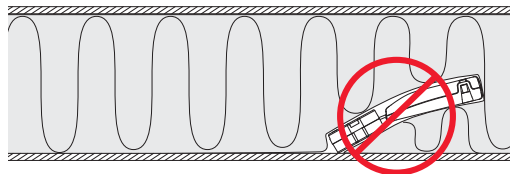
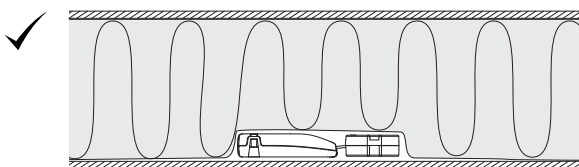
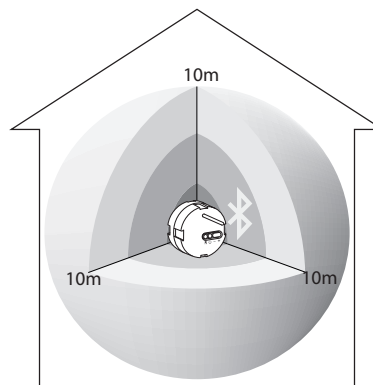
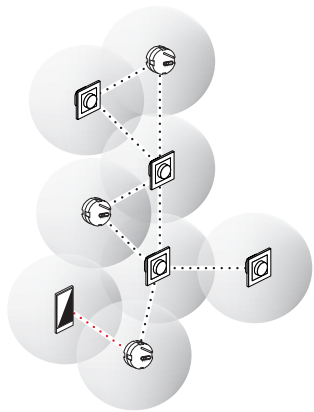

LEDDim App



Android OS 5.1, Ram 2.5GB mid-range CPUs<



iOS 9.0, iPhone 5s<



[www.sg-as.no/leddim/getapp/](http://www.sg-as.no/leddim/getapp/)

Pairing

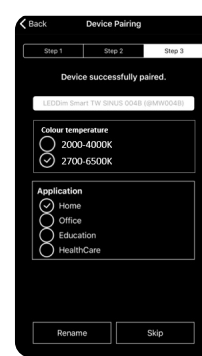
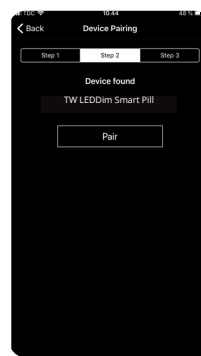
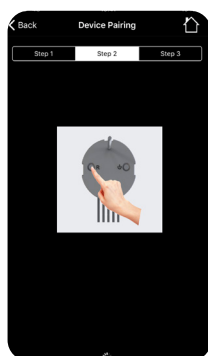
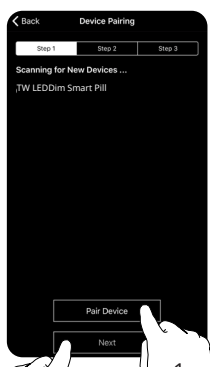
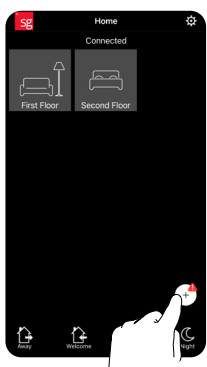

| 2000-4000K |       |      | Home    |       |      | Education     |       |      | Office        |       |      | Healthcare    |       |      |
|------------|-------|------|---------|-------|------|---------------|-------|------|---------------|-------|------|---------------|-------|------|
| Ambient    | 2000K | 20%  | Ambient | 2700K | 20%  | Relax         | 3000K | 50%  | Presentation  | 3000K | 30%  | Relax         | 3000K | 50%  |
| Relax      | 2200K | 40%  | Relax   | 2700K | 40%  | Dialogue      | 4000K | 70%  | Dialogue      | 4000K | 70%  | Dialogue      | 4000K | 70%  |
| Read       | 2700K | 100% | Read    | 3000K | 100% | Concentration | 4525K | 100% | Concentration | 4525K | 100% | Concentration | 4525K | 100% |
| Bright     | 4000K | 100% | Bright  | 4000K | 100% | Energy        | 6500K | 100% | Energy        | 6500K | 100% | Energy        | 6500K | 100% |

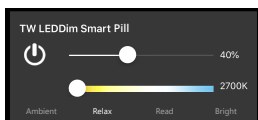
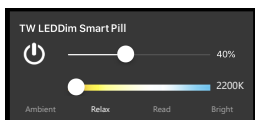

## Customise preset

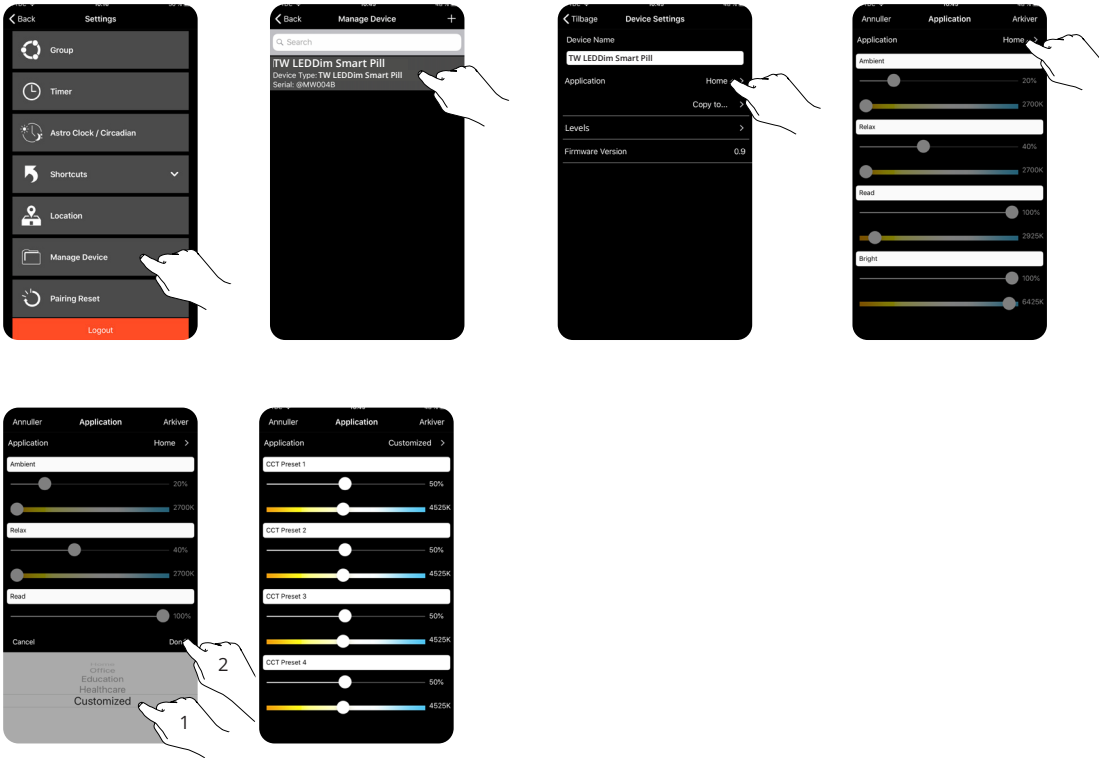

## Levels

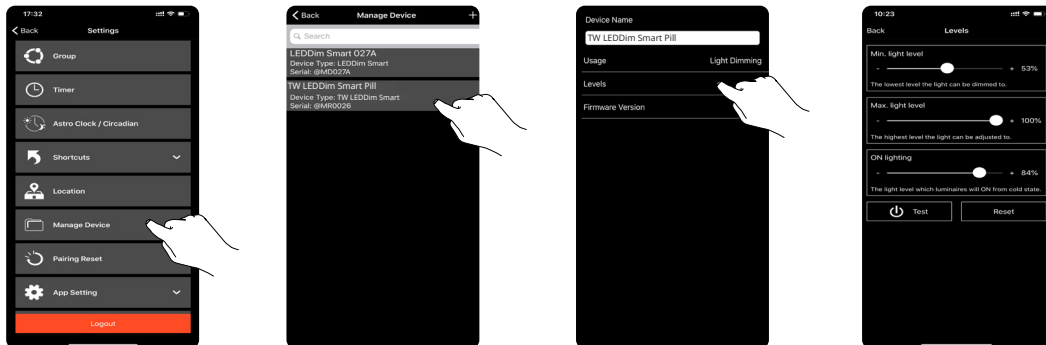

## Circadian

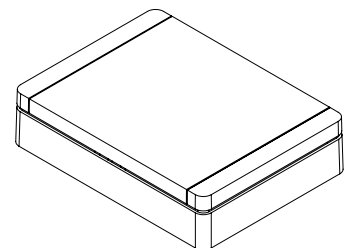
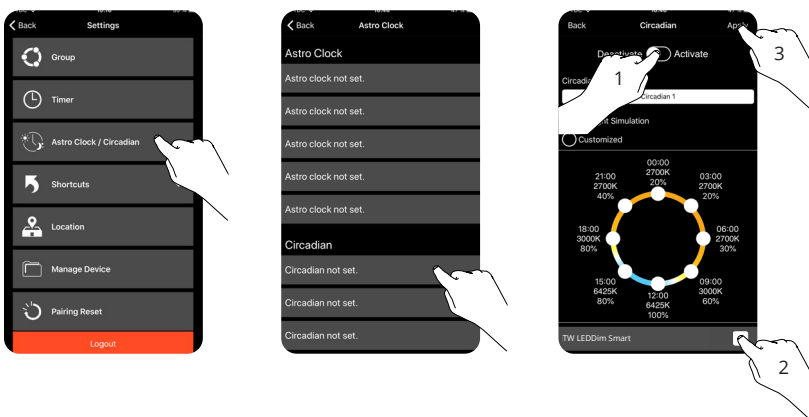

Use with SG Smart Gateway

## Circadian Customized

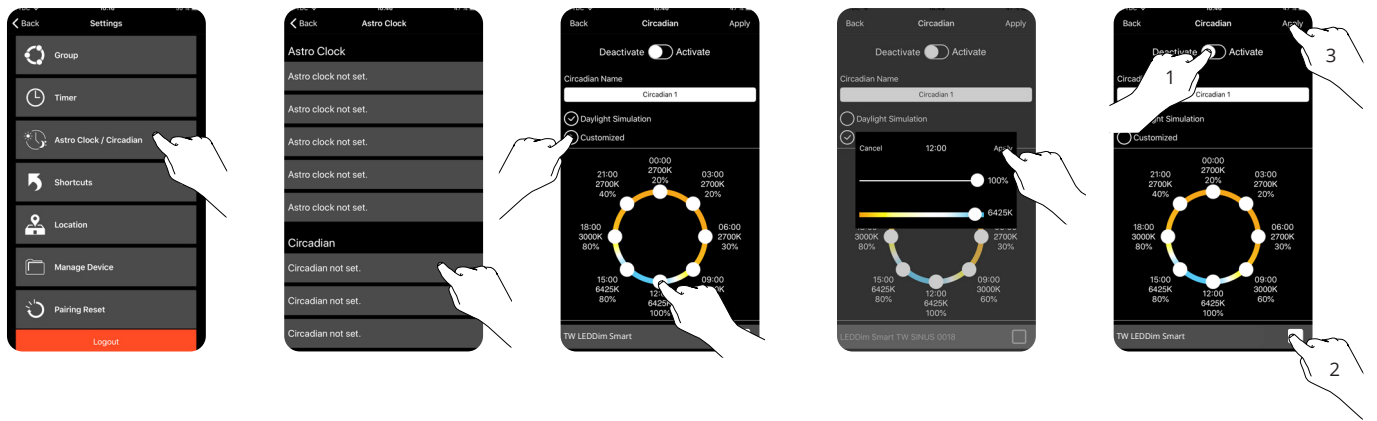

**NO:** Kan kun installeres og vedlikeholdes av en registrert installasjonsvirksomhet.

**DK:** Må kun installeres og vedligeholdes af uddannet elektriker.

**SE:** Skall installeras och underhållas av behörig elektriker.

**EN:** Only to be installed and maintained by an authorized electrician.

**FR:** Doit être installé et maintenu par un électricien qualifié.

**NL:** Mag alleen geïnstalleerd en onderhouden worden door een bevoegde elektricien.

**DE:** Dieses Produkt darf nur durch autorisiertes Personal (z.B. Elektro-Installateur) angeschlossen, in Betrieb genommen und gewartet werden.

**FI:** Asentaa ja huoltaa saa vain valtuutettu sähköasentaja

**NO:** Skru av strømmen før montering.

**DK:** Sluk for strømmen inden montering.

**SE:** Stäng av strömmen innan montering.

**EN:** Turn off power before installing.

**FR:** Couper le courant avant l'installation.

**NL:** Stroom uitschakelen voor u het toestel installeert.

**DE:** Vor Installationsarbeiten den Strom abschalten.

**FI:** Sammuta virta ennen kytkemistä